



EPILOG LASER

16371 Table Mountain Parkway

Golden, Colorado 80403

Phone 303-215-9171 - FAX 303-277-9669

www.epiloglaser.com

Procedure Title: Replacing the power supply

Machine Type: Helix

Tools Needed: Philips Head Screw Driver
5/16 nut driver
Wire Cutters

Equipment:



Meanwell Power Supply

Intro:

This procedure details steps to replacing the Meanwell power supply in the Helix. Before starting on this procedure, unplug the power cord from the machine.

Procedure:

1. Remove the back service panel.
2. Disconnect three of the electrical leads.
 - a. Disconnect the connectors holding the green with yellow stripe, black, and white lead.
 - b. Disconnect the farthest left connector holding the black and red lead.
 - c. Disconnect the connector holding red and black lead. This connector is directly under the left edge of the laser tube.

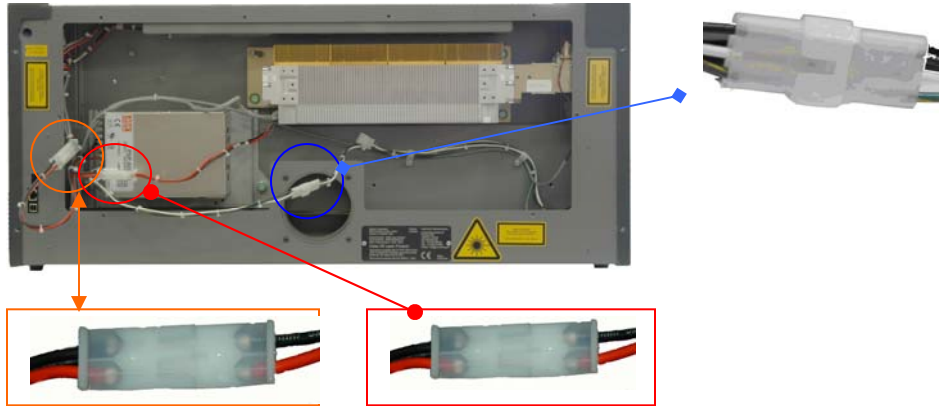

3. With a Philips head screw driver, unscrew the green screws located on each side of the power supply.

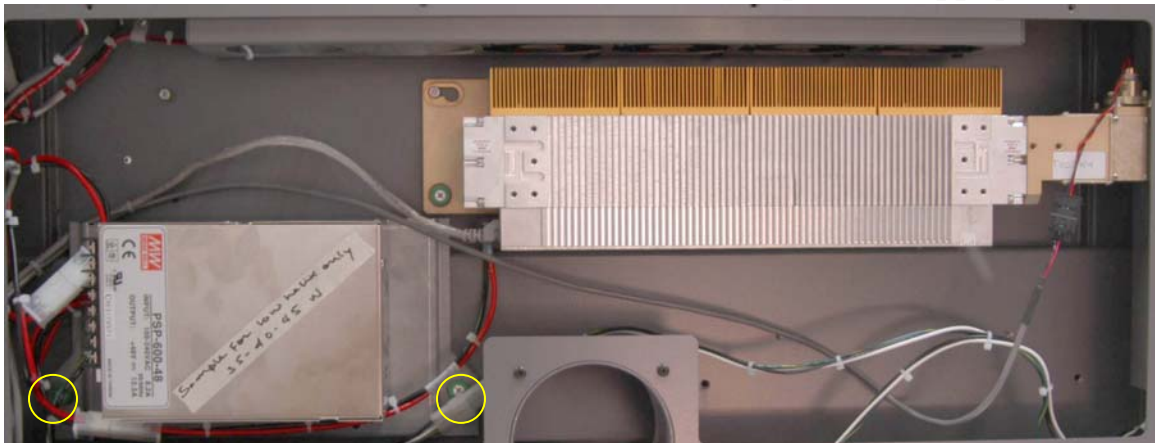

4. Replace the Meanwell power supply.



5. Reconnect the three electrical connectors.
 - a. Reconnect the connector with the green with yellow stripe, black, and white lead. There are two leads containing these wires, connect only the longer of the two.



- b. Reconnect the two connectors holding the red and black leads. The longer of the leads goes to the farthest left connector. The shorter lead connects to the lead from the laser tube.



6. Tuck in the wires under the power supply and replace the back service panel.



If you have any questions, please contact Epilog's
Technical Support
Phone 303.215.9171
Fax 303.531.7594
E-Mail tech@epiloglaser.com